

**stuv**

**[M]  
[r]  
[T]  
S**

The  
essential  
fire

The s[μ]M (microMega) is a ground-breaking wood-burning insert with retractable glass door that is particularly narrow, combining innovation with unrivalled performance. The unusual shape of its combustion chamber concentrates the fire right in the middle of the stove, while also offering a wide view to the outside. Logs are laid vertically, reminiscent of a welcoming camp fire and guaranteeing clean, efficient combustion. The s[μ]M's performance is exceptional, whether it's on a low or maximum power setting.

## wood-burning insert

---

appliance to be integrated  
into a wall or chimney breast

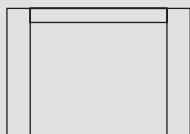





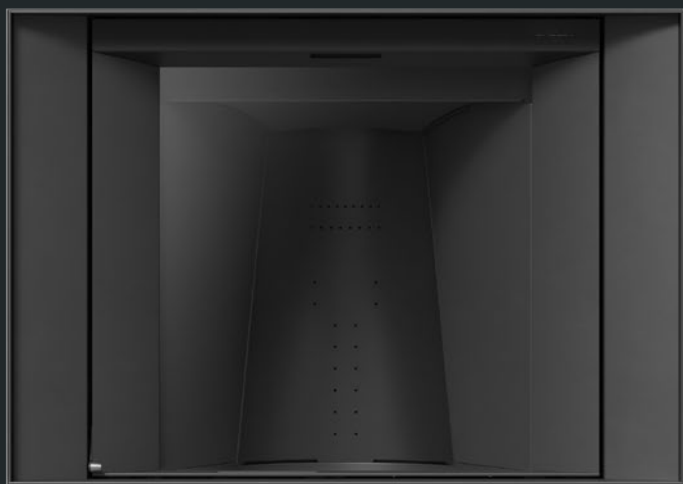

When you choose Stûv, satisfaction is guaranteed.

## s[ $\mu$ M]

---

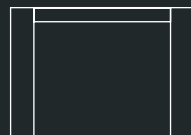

The s $\mu$ M is the first Stûv stove to incorporate one continuous line (ligne continue<sup>®</sup>), the brand's signature look. The curved line of the combustion chamber continues beyond the door frame, accentuating the panoramic view of the flames.

The s $\mu$ M has everything under control, offering impressive, efficient combustion combined with a very wide range of applications. Combining finesse, aesthetics and efficiency, this insert fulfils all your needs.

---

Performance\*

Energy efficiency class

---

Energy efficiency index

---

Output

---

Output range

---

Nominal efficiency

---

Seasonal efficiency

---

Fine particle emissions

---

CO emissions

---

NOx emissions

---

COV/COG emissions

---

Range of wood consumption

---

s[ $\mu$ M]

---

---

Logs - Maximum length

---

Weight

---

Standards

---

A+

---

110

---

11,0 kW

---

5 - 17 kW

---

82,6 %

---

72,6 %

---

4 mg/Nm<sup>3</sup>

---

0,05 % / 660 mg/Nm<sup>3</sup>

---

78 mg/Nm<sup>3</sup>

---

25 mg/Nm<sup>3</sup>

---

1,5 - 3,0 kg/h

---



---

30 cm

---

223 kg

---

EcoDesign 2022  
DEFRA

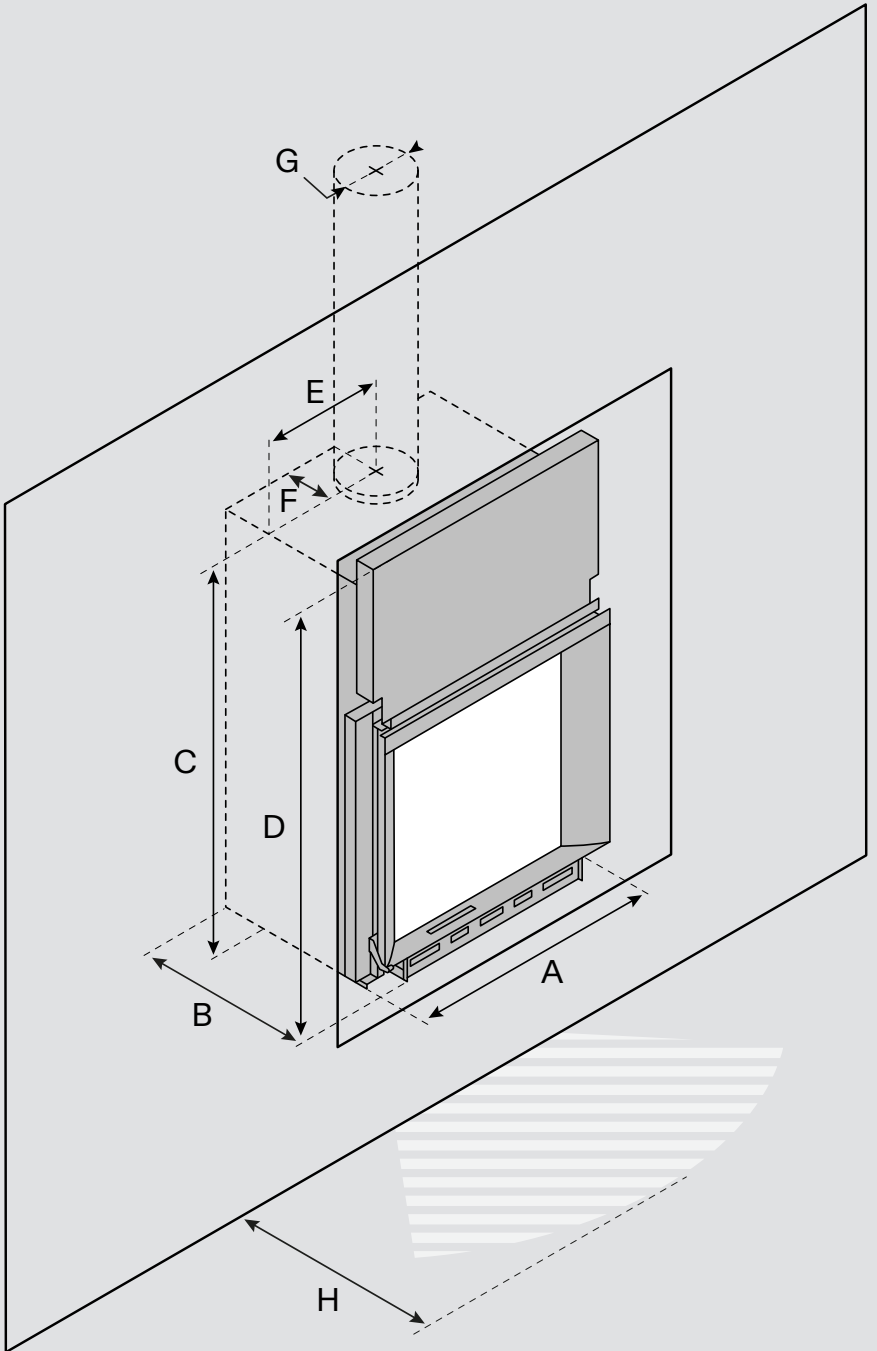

# s[μM]

---

[A] Width	802 mm*
[B] Depth	570 mm*
[C] Outlet height	1230 mm
[D] Device height	1360 mm*
[E] Flue axis - side	400 mm
[F] Flue axis - rear	160 mm
[G] Smoke outlet diameter	180 mm
[H] Forward radiation distance	1300 mm
∅ External air connection	100 mm
Optional ventilation kit	✓

## Glass

---

Width	580 mm
Height	625 mm

\* Caution: be sure to add the insulation thicknesses defined by your local regulations to the dimensions of the recess.

The appliance must be professionally installed by an authorised dealer/installer.



spM - Frame with metal panels

---

## Thin frame



W	1026 mm
H	720 mm

## Applied frame 4 sides



W	1146 mm
H	806 mm

## Frame with metal panels



W	1115 mm
H	702 mm

---

## Frames

The frames conceal the corners of the masonry around the fireplace, making it look wider. Frames are available in Stûv Black.



spM - Narrow front

---

## Narrow front



W	1295 mm
H	1362 mm
D	312 mm

The narrow front is also available in a version without a base for customization to suit your interior.

---

## Front panel

The front panel makes installation easier: it conceals the whole recess, avoiding the need for any masonry work. The frame is available in white.



spM - Wide cladding

---

## Wide cladding



W	1992 mm
H	1370 mm
D	674 mm

---

## Ready-to-fit

The ready-to-fit version is a great alternative for your wood-burner. It can be installed without the need for any major work, and incorporates all the features such as a log store and a convection air outlet. It is available in Stûv Black.



## Accessoires

---

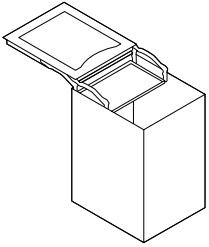

Mobilobox

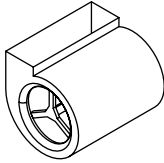

Fan

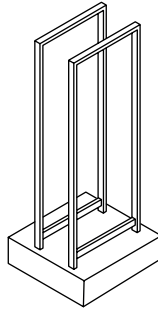

Log trolley

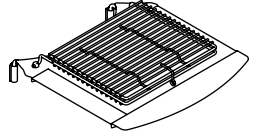

BBQ kit

## Colours

---

The cladding colours have been chosen to transcend time, offering elegance and understated style. If you'd like more customisation options for your project, other colours are available. Please speak to your authorised dealer.

White ○

Stûv Black ●

REMOVE

# FUNCTIONS



# S [μM]

[SIMPLE] Simplicity is the keyword when it comes to designing our products. This is true of their shape, installation, usage and maintenance. [EXCLUSIVE] The unique character of the sμM comes from its line, created by one uninterrupted curve connecting the inside and outside

of the stove, and from the contrast between the restrained dimensions of the combustion chamber (micro) and its wide opening (mega). This is a stove unlike any other. [EFFECTIVE] The sμM's shape contains a small cast iron combustion chamber. Its power can be controlled to give out however much heat you want, including in homes that do need a great deal of warmth. [FLEXIBLE] The smoke outlet has a diameter of 180mm and can be connected at the top or at the back. The device uses a natural convection system. It can also be fitted with a fan to circulate the warm air even more. [UNIQUE] The patented door seal system guarantees a flawless, long-lasting, airtight seal. This key component helps to manage the quality of the combustion. [INGENIOUS] The glass slides upwards for loading and for barbecue mode. The door can also tip forward to make it easier to clean the inside of the glass. [MULTIFACETED] The huge range of cladding options means that your stove can blend in with all sorts of different architectural styles. [CLEAN] Air sweeps over the glass and removes the dust produced by combustion for a flawless view of the flames. Designed to be almost complete, this means that the stove can carry on operating for longer without the need to remove the ash.

---

# The Stûv families

s[6]



s[16]



s[30]



s[ $\mu$ M]



---

s[21]



s[22]



s[P10]



s[P20]



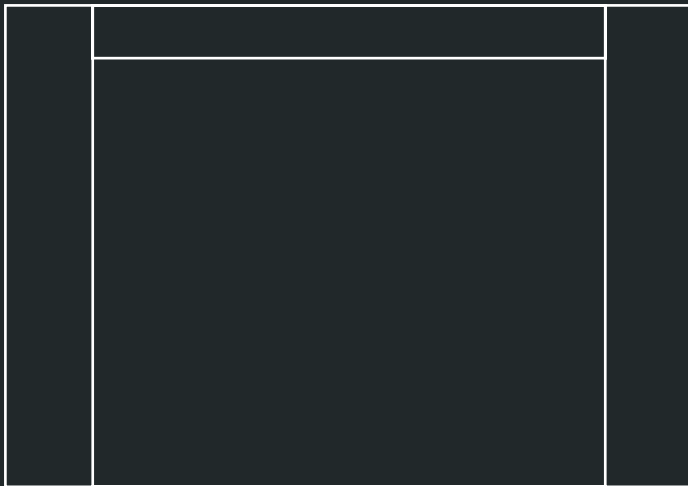

Documents and photos are not contractual. Stûv reserves the right to make changes without notice.  
This catalogue has been carefully compiled; however, we decline all responsibility for any errors.

Stûv fireplaces are designed and manufactured by Stûv sa - Belgium - [stuv.com](http://stuv.com)